

Q-NEX Touch Panel CPL10 User Manual



Q-NEX Touch Panel is a versatile control panel with capacitive touch, working with Q-NEX Networked Media Processor (NMP) to realize central control of classroom devices. Touch Panel can be connected to NMP on the same LAN. Besides, this panel is with human-centered design that the homepage template can be changed according to different user habits.

Returnstar Interactive Technology Group Co., Ltd.

Packing List

- Touch Panel*1
- Power Supply*1
- I/O Connector*1
- Wall Mount Bracket*1
- Desktop Stand*1
- Screw*8

Product Overview

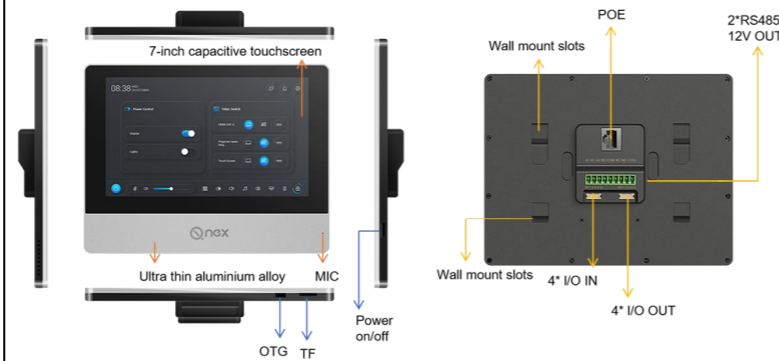

-1-

1.Connect to NMP with CAT Cable

- 1.1. Screw the wall mount bracket to the desktop stand.
- 1.2. Connect the Touch Panel to network and power up. There are three ways for connection:

- (1) Connect Touch Panel to NMP by network cable, and power through 12V adapter.
- (2) Connect Touch Panel and NMP to the same switch, and power Touch Panel through 12V adapter.
- (3) Connect both Touch Panel and NMP to one PoE switch, then no power supply is required for Touch Panel.

Note:
 (1)The LAN ports of NMP 210-G and NMP 220-R don't support POE.
 (2) Touch Panel must be on the same LAN as NMP.

Warning

Do not power Touch Panel through adapter and POE at the same time, it will cause Touch Panel to be short-circuited and burned. This kind of damage is not covered by the warranty.

-2-

1.3. Fasten the wall-mounted bracket into the slots of Touch Panel and make sure it is fixed.

1.4. Initial settings

(1) Make sure that NMP is connected to the network (refer to NMP Quick Guide). Log in to the Q-NEX Dashboard -Devices-Processor Manager and check the IP address of this NMP.

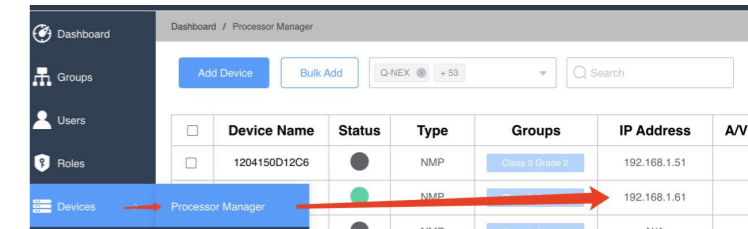

(2) Input the IP address on the Touch Panel and click Connect.

-3-

3.Audio and video device control.

Functions	Descriptions
Video Source	Switch the video input sources among three displays
Audio Source	Switch between the audio of HDMI In and Audio In (Note: the audio can be switched only when it's from HDMI In to HDMI Out A)
Volume Adjustment	Adjust mic volume/treble/bass, and mic+audio volume/treble/bass
Power Control	Power on and off the Display and External
Curtain Control	Roll up/down and stop the curtain
A/C Control	Control power/mode/temperature/fan status
Remote Control	Infrared remote control (learning code refers to NMP user manual)

-5-

4. Broadcast Control

4.1. When NMP receives non-compulsory broadcast, the prompt of In Broadcasting with Quit button will appear on the screen:

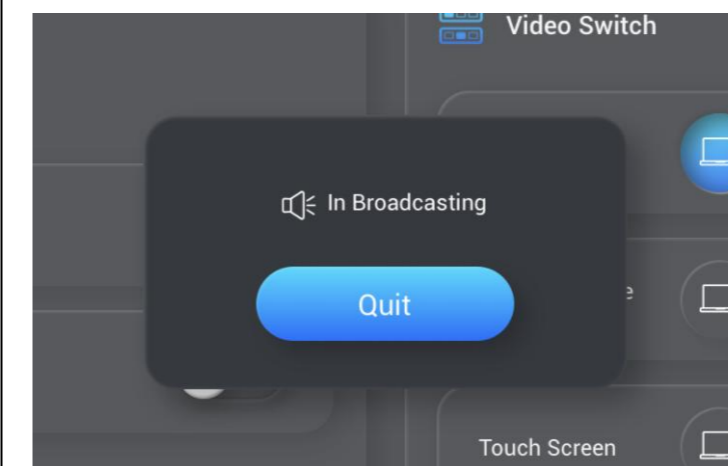

Click "Quit" to stop broadcasting.

-6-

4.2. When NMP receives compulsory broadcast, the prompt of In Broadcasting will appear on the screen:

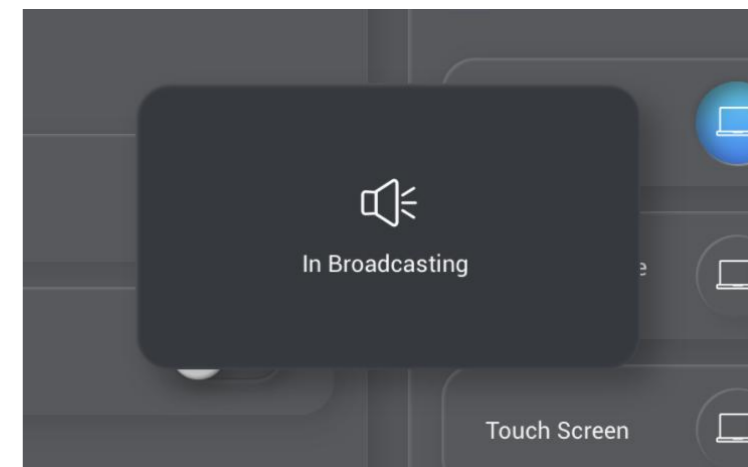

You cannot stop broadcasting and Touch Panel is not available for use during the time. Please focus on listening to the broadcast.

5. Touch Panel Settings

5.1. Set up the functions as below for Touch Panel:

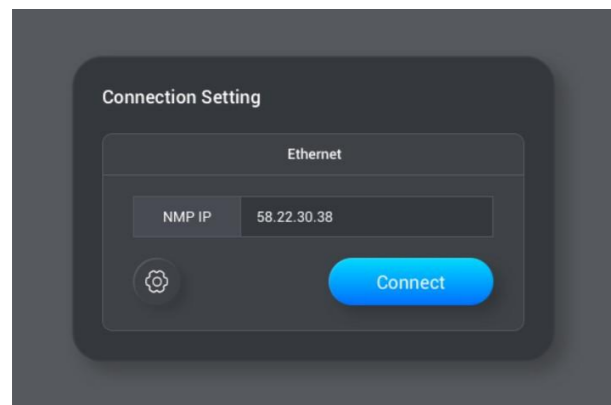

-7-

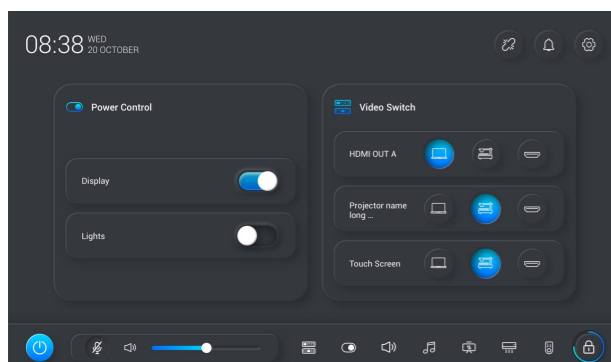

(3) It will enter the homepage of Touch Panel after connecting successfully.

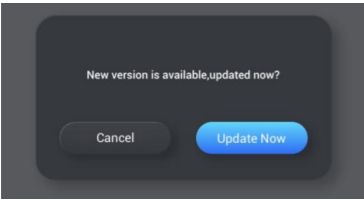

-4-

Software Update	Click "Update" and the device will automatically detect whether the current software is the latest version. Touch panel will restart after the update completed. The prompt "New version is available, updated now?" will pop up while a new version is released. This software supports OTA, and the system will automatically detect new version and prompt the user whether to download and install.
	
Language	Language option : Chinese/English
Screen Brightness	Drag the slider to adjust the screen brightness, which can be automatically saved. 
Time of auto screen lock	Set the interval for automatic screen lock without operation: 15 sec / 30 sec / 1 min / 2 min / 5 min / 10 min / Never auto screen lock
Time of auto off screen	Set the interval of automatically turning off the screen without operation: 15 sec / 30 sec / 1 min / 2 min / 5 min / 10 min / Never auto off screen
Time and date	Set displayed time and date

-8-

5.2. Screen Lock Setting

NMP connects to network after successful connection of NMP and Touch Panel:
Log in to Q-NEX Dashboard - Devices - Processor Manager, choose NMP to edit.

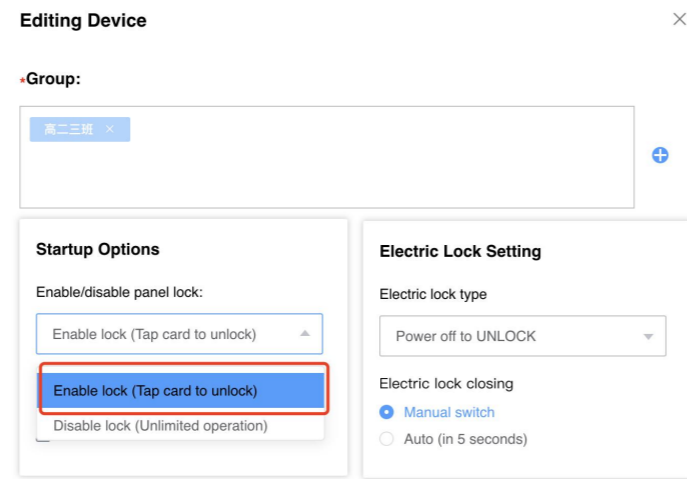

Choose "Enable lock (Tap card to unlock)" in Startup Options and save.

Press the lock button to lock Touch Panel, and tap the card in the CARD area on the right side of the locked screen to unlock it.

-9-

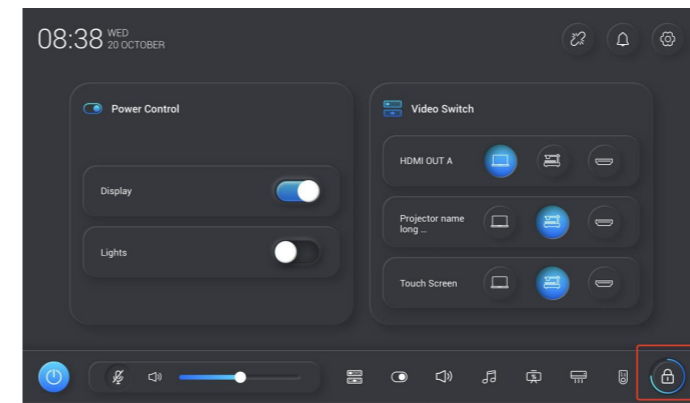

-10-

If the screen lock is disabled:

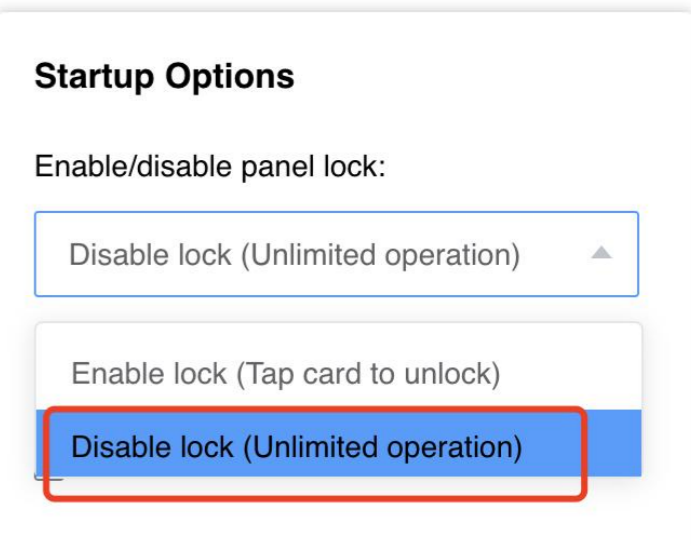

Click the unlock button to unlock it when the screen is locked.

-11-

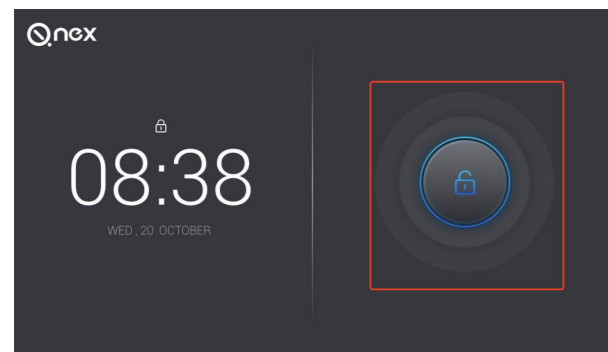

5.3. Homepage Template Setting

Choose one of the homepage templates

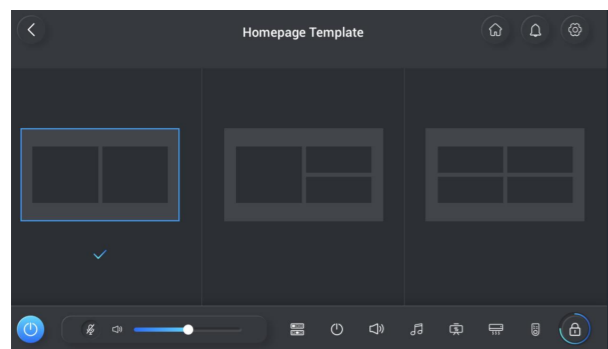

-12-

Click on the template picture to enter the Widget page, long press and drag the widget to the position you want and click save to take effect. Please note that the widgets cannot be repeated.

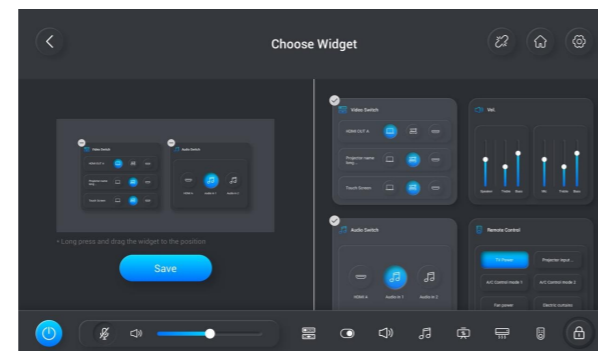

-13-

6. Troubleshooting

- (1) No response while clicking Lock:
Check if you have set **Swiping card for powering on** at Q-NEX Dashboard.
- (2) Touch Panel is unable to connect to NMP:
Check if the IP address of NMP is correct and if Touch Panel is on the same LAN as NMP.
- (3) Infrared functions don't work (like A/C, remote control, etc.).
Please check if NMP has successfully connected to the network.
- (4) Unable to access the device ID.
Please check if NMP has successfully connected to the network.
- (5) Unable to OTA update.
Please check if NMP has successfully connected to the network.

Please contact Q-NEX sales team for other questions:
info@qnextech.com

-14-

-15-